

DESCRIPTION	REVISIONS	DATE

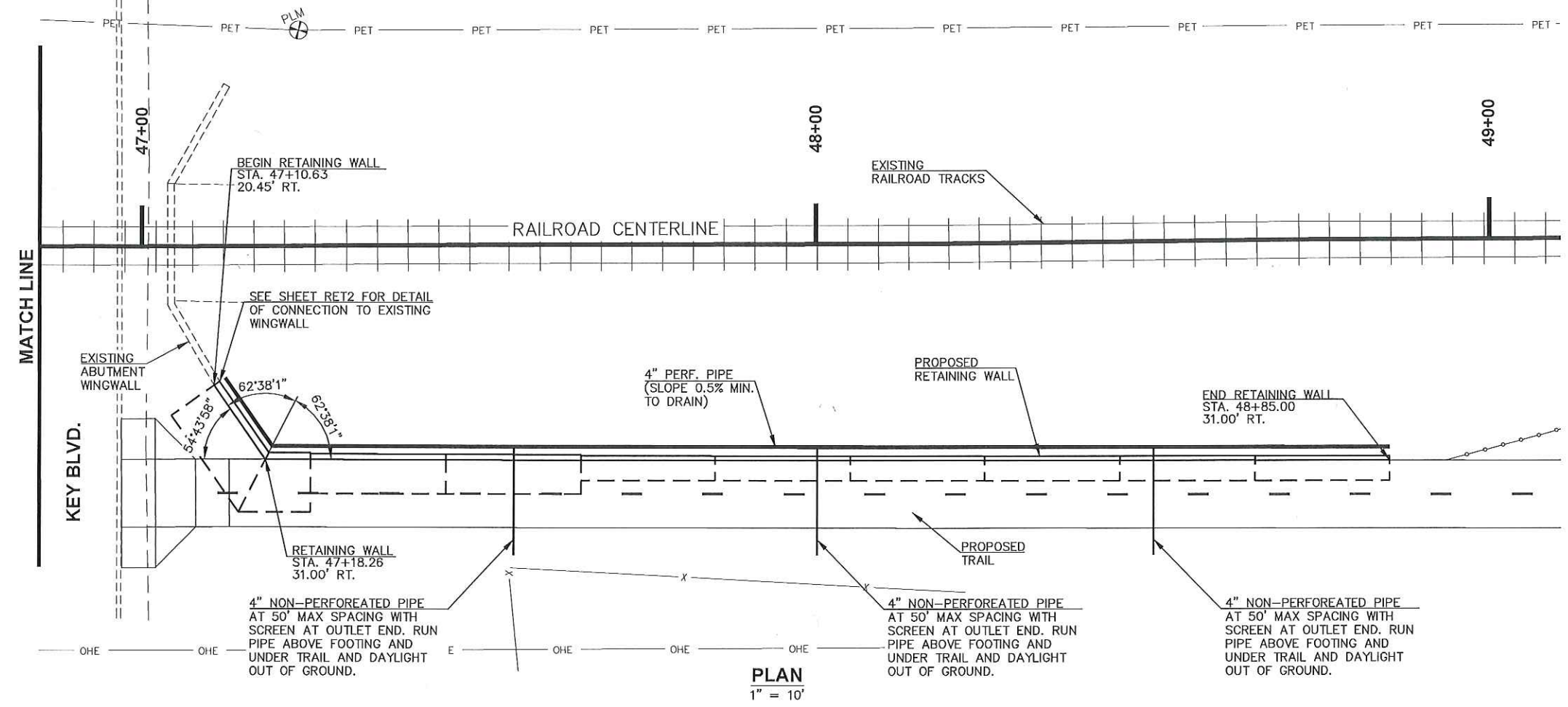

PLAN
1" = 10'

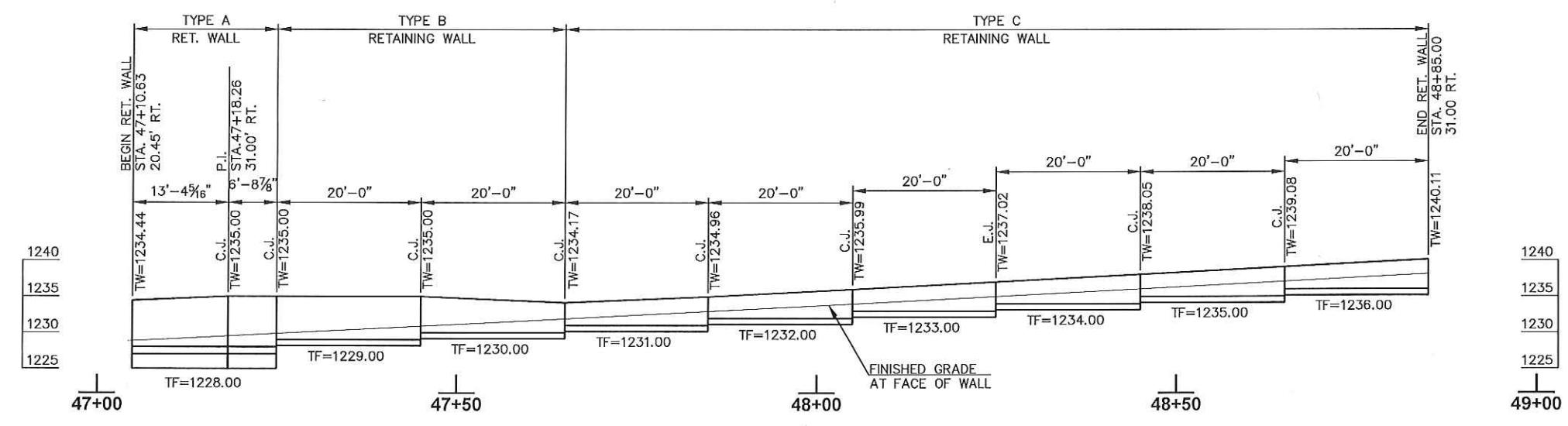

ELEVATION
1" = 10'

- NOTES:**
- FOOTING EXCAVATIONS SHALL BE KEPT CLEAN OF WATER AND DEBRIS.
 - FOOTING SHALL BEAR ON SOIL AT LEAST TWO FEET BELOW FINISH GRADE.
 - TW DENOTES TOP OF WALL.
 - TF DENOTES TOP OF FOOTING.
 - C.J. DENOTES CONSTRUCTION JOINT.
 - E.J. DENOTES EXPANSION JOINT.

PLOTTED: Friday, October 28, 2016 @ 11:38AM

MKE ENGINEERING INC.
 JONATHAN T. HISEY
 OKLA. REG. NO. 23127

DESIGN	J.T.H.	CITY OF MIDWEST CITY	OKLAHOMA COUNTY
DRAWN	H.W.L.	RETAINING WALL PLAN AND ELEVATION (SHEET 2 OF 2)	
CHECKED	J.T.H.		
APPROV.	J.T.H.	JOB PIECE NO. 31435(04)	SHEET NO. RET4
SQUAD	MKEC ENG.		